

# AD HOCKERY

from LEX LOCI ... 1 DECEMBER 2015

*An occasional one-pager from The Public Land Consultancy*

## Deep Fine Leg, Koondrook



*The victorious Barham-Koondrook under 17 cricketers.*

Looking at the aerial photo of Koondrook cricket ground, you'd never guess that two thirds of it is a Crown reserve (coloured grey on the plan), and one third is freehold owned by the Shire of Ganawarra (coloured buff).

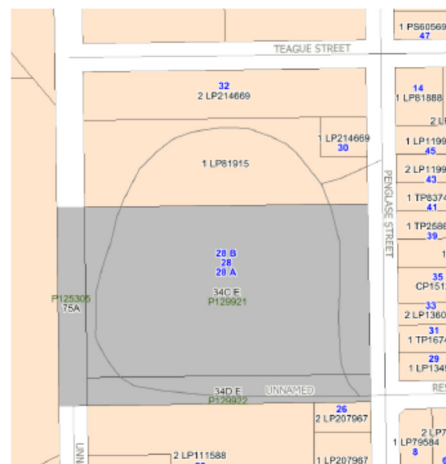

Does it matter? Well, maybe. When the Shire wanted to build new pavilions, it put them in the north-west corner, not the south east – thereby retaining ownership and avoiding all the Crown land red tape. At a match, two thirds of the spectators are subject to Crown land regulations; the other third are subject to Council's local laws. Two thirds of the circumferential road is subject to the Road Management Act, and one third isn't.

Can it be fixed? Solution one: Council surrenders the one-third to DELWP (which doesn't want it); solution two: Government sells the two-thirds to Council (which isn't prepared to pay for something it already has practical control over). Time to call for the third umpire.

See you there! Lex Loci